

VICINITY MAP
SCALE: 1"=±800'

- LEGEND:**
- PARCEL BOUNDARY
 - - - RIGHT-OF-WAY
 - - - TAX DITCH EASEMENT
 - - - PROPOSED PERMANENT EASEMENT
 - - - PROPOSED LOTLINE
 - - - PROPOSED ROLLED CURBING
 - - - PROPOSED SIDEWALK
 - - - PROPOSED SHARED USE PATH
 - - - PROPOSED STORMWATER BASIN
 - - - EXISTING CONTOURS
 - - - PROPOSED CONTOURS
 - H.P. HIGH POINT TYP.
 - - - PROPOSED 8" WATER MAIN
 - - - 8" SS PROPOSED 8" SANITARY SEWER
 - PROPOSED SANITARY SEWER MANHOLE
 - - - EXISTING 12" WATER MAIN ON SUBSTATION ROAD
 - - - 30" SS EXISTING 30" SANITARY SEWER ON SUBSTATION ROAD

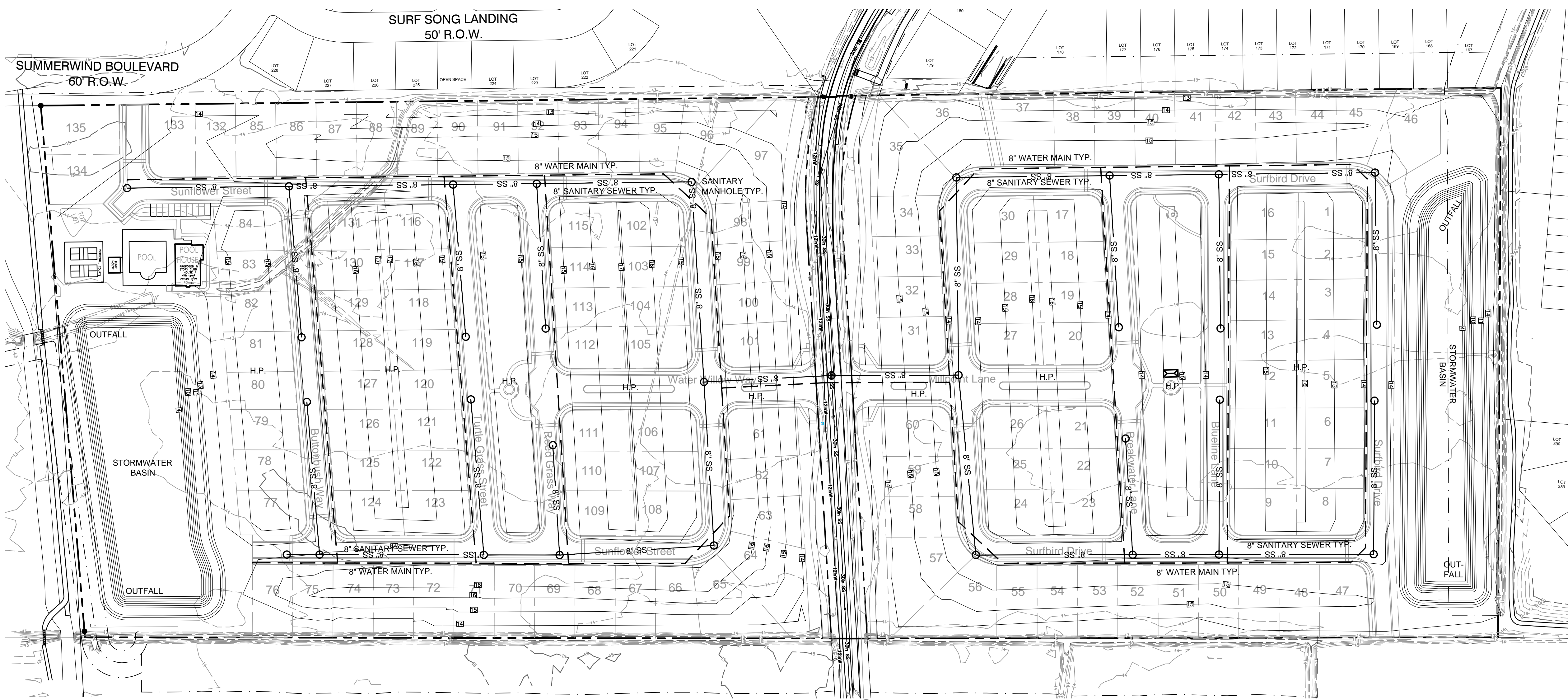

SCALE: 1"=100'

OWNER'S PLAN DEVELOPMENT APPROVAL:
I, as Owner/ Developer of the project shown, hereby approve these plans as shown or otherwise noted.

Dianne Archut _____ Date
E. Johnson Holdings, LLC.

DEVELOPER'S PLAN DEVELOPMENT APPROVAL:
I, as Owner/ Developer of the project shown, hereby approve these plans as shown or otherwise noted.

Joel Sens _____ Date
Stafford Street Capital, LLC

ENGINEER'S STATEMENT:
I certify that the proposed site plan was compiled under my supervision.

Robert Plitko, Jr. _____ Date
DE PE 14093

PRELIMINARY GRADING & UTILITIES PLAN

REVISIONS

LAND DESIGN
INC.
Land Planning / Landscape Architecture
One Square, Suite #3, 53 Atlantic Ave.
302.837.1919 / landzn@aol.com

PLITKO, LLC
ENGINEERING
53 ATLANTIC AVE., STE 3
OCEAN VIEW, DE 19770
Phone (302)-222-2075

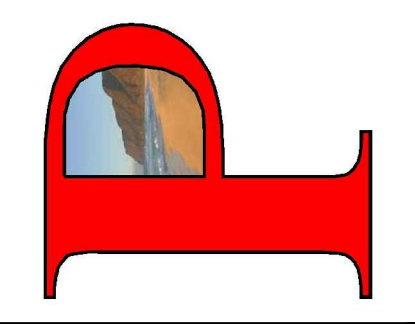

PRELIMINARY PLAN
EGRET SHORES
(FORMERLY KNOWN AS SUBSTATION ROAD SUBDIVISION)
SUBSTATION ROAD (SCR 366)
TOWN OF MILLVILLE SUSSEX COUNTY DELAWARE

SITE PLAN: T/JF
DRAWING: RWB
REVIEW: RP

DATE
12/10/20

SHEET
2
OF 3 SHEETS

P:_Proj19\Sense-SubstationRD\Curren\201116-Prelim Grading.dwg, 12/10/2020 12:07:59 PM, DWG To PDF.pc3, 1:1, LANDDESIGN, INC.